

**规格SPECIFICATIONS**

间距(PITCH): 2.5mm  
极数(Poles): 2~15  
适用电线范围(Useable wire range): AWG30#~22#  
适用印制板厚度(Applicable PC board thickness): 0.8~1.6mm  
额定电流(Current rating): 3A, AC, DC  
额定电压(Voltage rating): 250V, AC, DC  
工作温度(Working Temperature): -25℃ ~ +85℃  
耐压值(Withstand voltage): 1000V, AC /min  
接触电阻(Contact resistance): ≤ 0.01Ω  
绝缘电阻(Insulation resistance): ≥ 1000mΩ

**材料MATERIAL**

孔座(HOUSING): 尼龙66 UL94V-0 (NYlon66 UL94V-0)  
针座(PIN HEADER):  
1、基座(WATER): 尼龙66 UL94V-0 (NYlon66 UL94V-0)  
2、插针(PIN): 黄铜(BRASS)  
端子(TERMIAL): 磷青铜(PHOSPHOR BRONZE)

**EH-T**

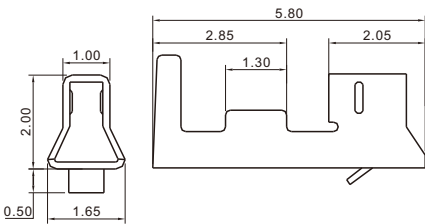

**EH-Y**

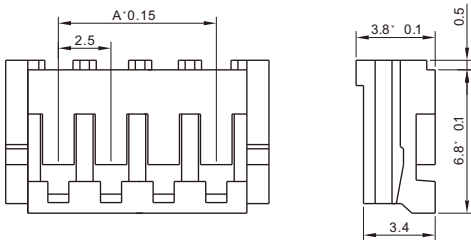

**EH-A**

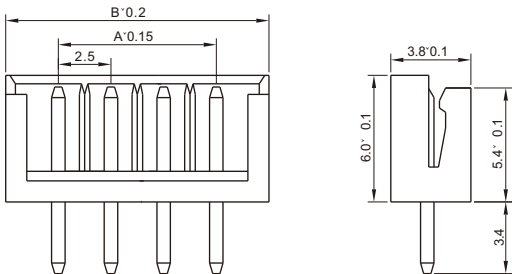

**EH-AW**

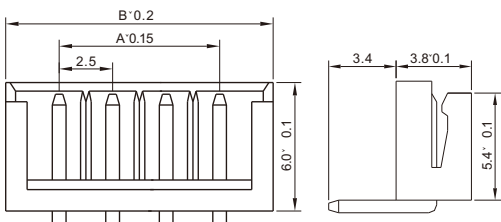

**EH-AWD**

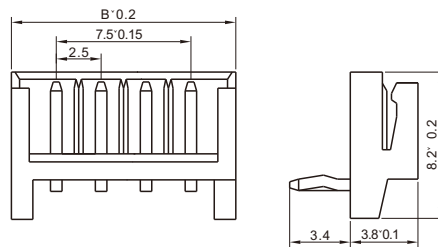

线数 poles	型号(Type)					A	B
2	EH-2Y	EH-2A	EH-2AW	EH-2AWD		2.50	7.50
3	EH-3Y	EH-3A	EH-3AW	EH-3AWD		5.00	10.00
4	EH-4Y	EH-4A	EH-4AW	EH-4AWD		7.50	12.50
5	EH-5Y	EH-5A	EH-5AW	EH-5AWD		10.00	15.00
6	EH-6Y	EH-6A	EH-6AW	EH-6AWD		12.50	17.50
7	EH-7Y	EH-7A	EH-7AW	EH-7AWD		15.00	20.00
8	EH-8Y	EH-8A	EH-8AW	EH-8AWD		17.50	22.50
9	EH-9Y	EH-9A	EH-9AW	EH-9AWD		20.00	25.00
10	EH-10Y	EH-10A	EH-10AW	EH-10AWD		22.50	27.50
11	EH-11Y	EH-11A	EH-11AW	EH-11AWD		25.00	30.00
12	EH-12Y	EH-12A	EH-12AW	EH-12AWD		27.50	32.50
13	EH-13Y	EH-13A	EH-13AW	EH-13AWD		30.00	35.00
14	EH-14Y	EH-14A	EH-14AW	EH-14AWD		32.50	37.50
15	EH-15Y	EH-15A	EH-15AW	EH-15AWD		35.00	40.00